

Revised BoQ

Estimating and costing of GI chain link fencing boundary of Higher Secondary School of IIT Patna, Bihta Campus

Sl No.	DSR Item No.	Description of Item	Unit	No	L	B	H	Total Quantity	DSR Rate 2021	Total Amount
1	2.6	Earth work in excavation by mechanical means (Hydraulic excavator)/ manual means over areas (exceeding 30 cm in depth, 1.5 m in width as well as 10 sqm on plan) including getting out and disposal of excavated earth lead upto 50 m and lift upto 1.5 m, as directed by Engineer-in-charge.								
	2.6.1	All kinds of soil for foundation of Iron Angle	cum	90	0.4	0.4	0.7	10.08		
		B/W foundation(Gate portion)	cum	1	6	0.4	0.4	0.96		
		Total						11.04	205.45	2268.17
2	2.25	Filling available excavated earth (excluding rock) in trenches, plinth, sides of foundations etc. in layers not exceeding 20cm in depth, consolidating each deposited layer by ramming and watering, lead up to 50 m and lift upto 1.5 m. , Iron Angle foundation	cum	90	0.1	0.1	0.3	0.27		
		B/W foundation	cum	1	6	0.1	0.4	0.24		
		Total						0.51	253.95	129.51
3	4.1	Providing and laying in position cement concrete of specified grade excluding the cost of centering and shuttering - All work up to plinth level :								
	4.1.3	1:2:4 (1 cement : 2 coarse sand (zone-III) derived from natural sources : 4 graded stone aggregate 20 mm nominal size derived from natural sources)	cum	1	6	0.4	0.1	0.24	7365.15	1767.636
4	10.16	10.16 Steel work in built up tubular (round, square or rectangular hollow tubes etc.) trusses etc., including cutting, hoisting, fixing in position and applying a priming coat of approved steel primer, including welding and bolted with special shaped washers etc. complete.								
	10.16.1	Hot finished welded type tubes.								
		Vertical(tube)60*40*2.6 mm, qty- 2.2m*90 = 198 m								
		Horizontal(tube) 40*40*2.6mm Qty- 1.3m*90+ 3.0m*2*90=657 m								
	1004/0091	12 mm dia. TMT bar Qty- 0.300*2*90nos. = 54 m@0.89kg/m= 48.06 kg.1004 Average rate of Mild steel round bars for reinforcement quintal 4850.00, and 0091 Welding charges of shear key to existing reinforcement each 5.00	kg	1				48.06	53.50	2571.21
		Qty= 198m@3.73kg/m+ 657m@2.92kg/m= 2656.98=2660 kg, Total	kg					2660	154.90	412034.00

5	13.61	Painting with synthetic enamel paint of approved brand and manufacture to give an even shade :									
	13.61.1	Two or more coats on new work	sqm	1				130	131.45	17088.50	
6	16.70	Providing and fixing G.I. chain link fabric fencing of required width in mesh size 50x50 mm including strengthening with 2 mm dia wire or nuts, bolts and washers as required complete as per the direction of Engineer-in-charge.									
	16.70.1	Made of G.I. wire of dia 4 mm	sqm	90	3		1.5	405	859.5	348097.50	
7	6.1	Brick work with common burnt clay F.P.S. (non modular) bricks of class designation 7.5 in foundation and plinth in:									
	6.1.2	Cement mortar 1:6 (1 cement : 6 coarse sand)	cum	1	6	0.3	0.5	0.9	6658.28	5992.45	
8	2.28	Surface dressing of the ground including removing vegetation and in-equalities not exceeding 15 cm deep and disposal of rubbish, lead up to 50 m and lift up to 1.5 m									
	2.28.1	All kinds of soil	sqm	90	0.4	0.4		14.4	28.15	405.36	
9	10.4	Providing and fixing 1 mm thick M.S. sheet sliding-shutters, with frame and diagonal braces of 40x40x6 mm angle iron, 3 mm M.S. gusset plates at the junctions and corners, 25 mm dia pulley, 40x40x6 mm angle and T- iron guide at the top and bottom respectively, including applying a priming coat of approved steel primer	sqm	1	2.4	1.5		3.6	5374.35	19347.66	
10	10.5	Providing and fixing 1mm thick M.S. sheet door with frame of 40x40x6 mm angle iron and 3 mm M.S. gusset plates at the junctions and corners, all necessary fittings complete, including applying a priming coat of approved steel primer.									
	10.5.1	Using M.S. angels 40x40x6 mm for diagonal braces	sqm	1	1	1.5		1.5	4781.15	7171.73	
									Total, Rs.		816873.72

Rs. 8, 16, 874.00/- only, Rs. Eight Lakhs Sixteen Thousand Eight Hundred and Seventy Four only
Revised BoQ exceeded 6.36% of approved cost of work

RAMM
10/11/22

pl. up to tender.

Approved for

EE civil

A. Shukla
10/11/22
AE Civil

Revised

on 10/11/2022

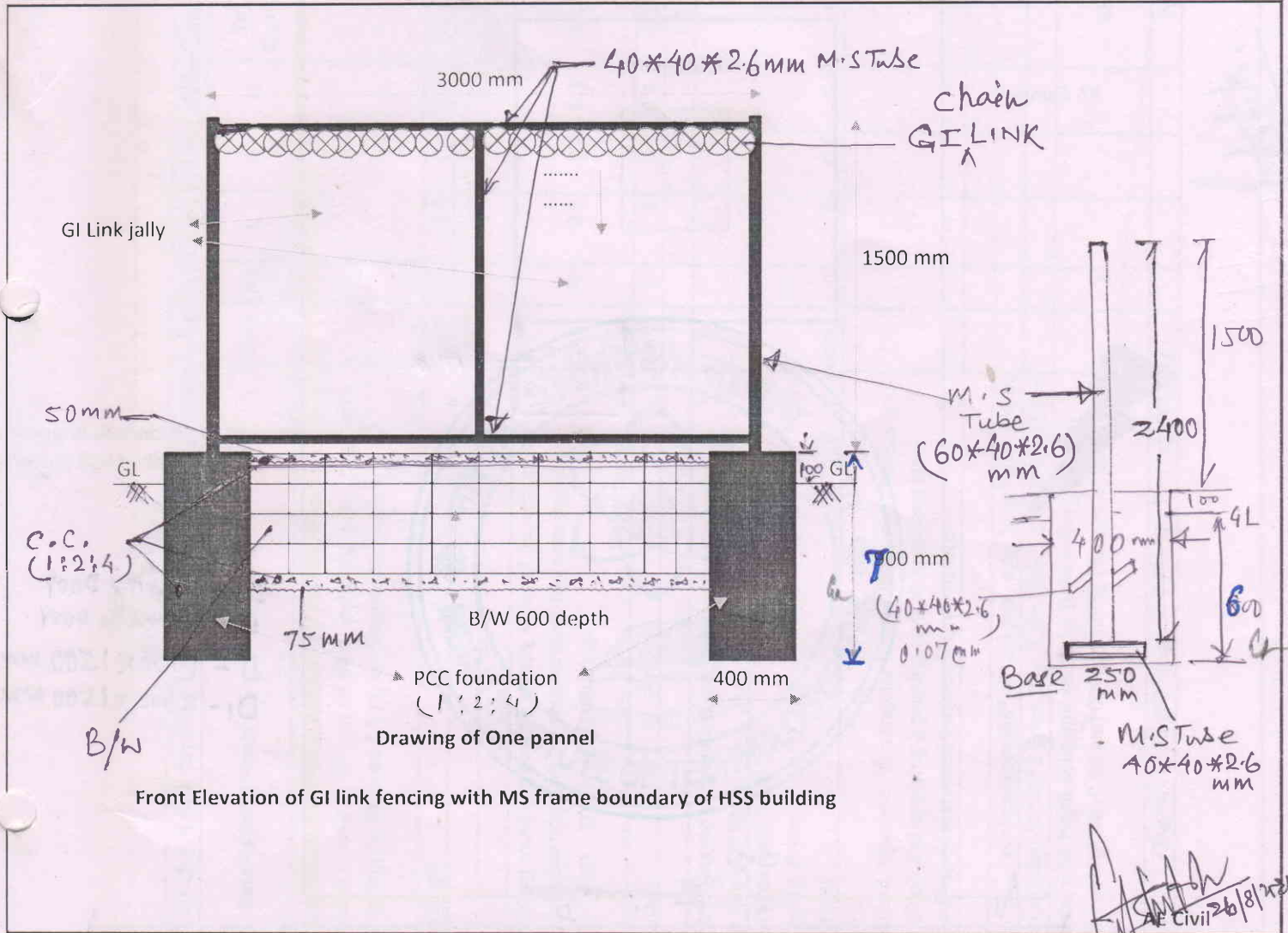

[Signature]
AE Civil 26/8/22
AEC

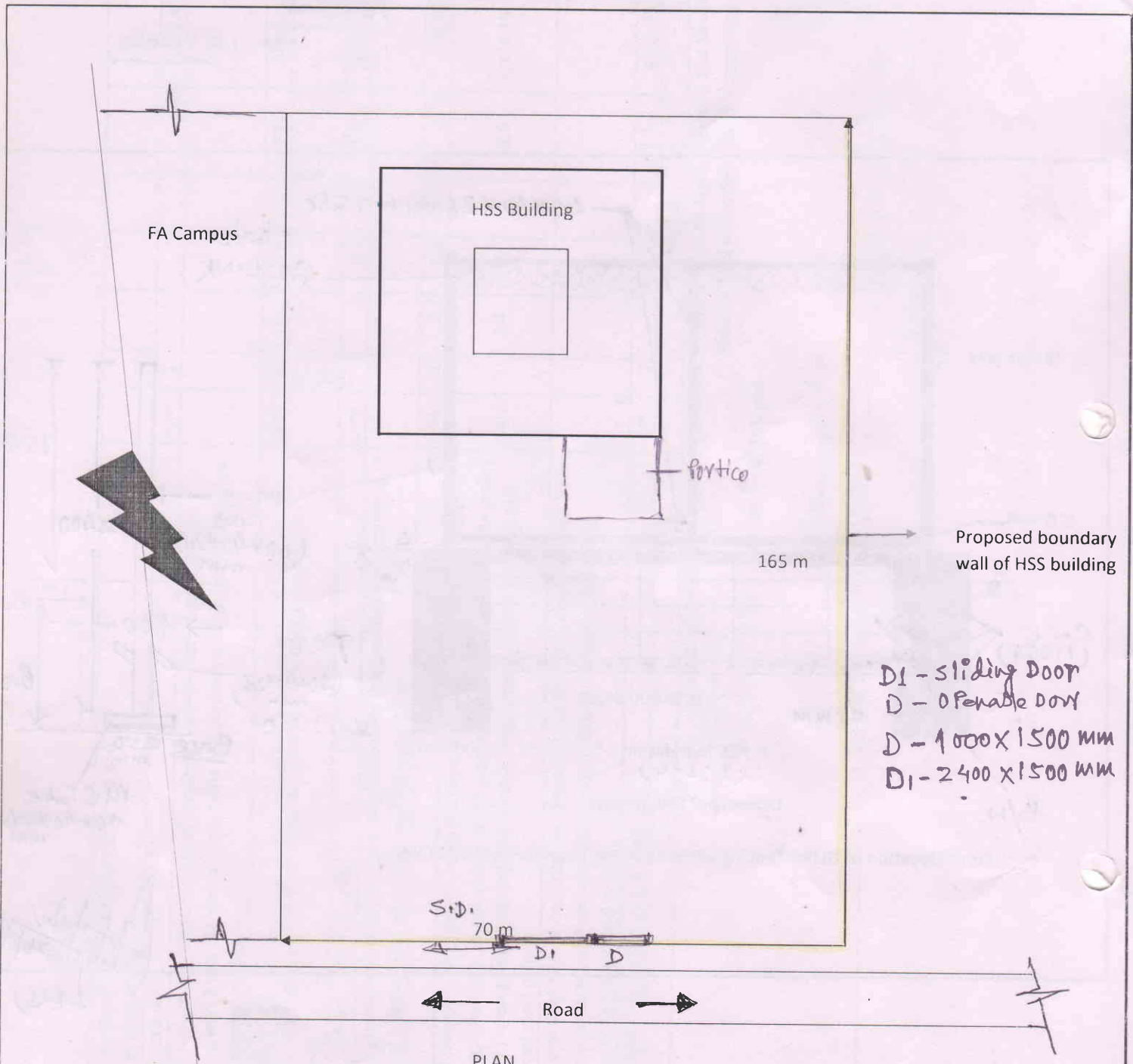

Drawing of GI chain link fencing boundary of Higher Secondary School of IIT Patna, Bihta Campus

[Handwritten Signature]
 26/8/2022
 AE Civil